

From MaxxAir Vent Corporation



Read and Save
These Instructions



CSA approved.

MaxxFan™ Installation Instructions

WARNING - To reduce risk of fire, injury to persons or damage to property, use only in the manner intended by MaxxAir Vent Corp. If you have questions, contact MaxxAir Vent Corp. @ 1-800-780-9893



NOTE: Refer to supplied attachments for further instructions regarding the model you have purchased.

The MaxxFan installs into a standard RV roof opening of 14 by 14 inches.

To determine if your roof opening is correctly sized, simply remove the interior ceiling garnish trim ring of your existing roof vent and measure the ceiling opening or verify the opening is large enough by sliding the MaxxFan interior Garnish trim ring into the opening.

Due to the exhaust/intake louvers that face the rear of the vehicle, the MaxxFan requires a roof area clear of obstructions such as air conditioners, storage boxes, etc. for at least 8 inches to the rear of the existing standard roof vent flange outer rear edge.

The MaxxFan is designed for a minimum roof thickness of 1 1/8 inches to a maximum of 6 1/2 inches. If your roof thickness is less than 1 1/8 inches, build additional thickness at the ceiling opening using wood or other suitable material.

The MaxxFan requires a minimum 12 Volt DC, 5 amp service. Confirm that the circuit you intend to use will accommodate the additional load. Use the proper gauge stranded wire for electrical connections.

Step 1

Remove the old existing roof vent. Remove all old roof sealant for a minimum of 2" entirely around the roof opening.

Place the **MaxxFan** Roof Receiving Flange (ref. photo #3) into the roof opening and trace a pencil line around it to verify the clean seal area that will be required. Note that the Roof Receiving Flange must be centered in the roof opening with the metal clips facing the sides of the vehicle (not facing the front or rear of the vehicle).

Step 2

Apply factory recommended roof sealant to the area traced with the pencil. Apply roof sealant carefully so that no gaps are present that may allow water to enter.

Step 3

Fasten the Roof Receiving Flange to the roof with the screws provided.

Apply additional roof sealant over the screw heads and around the edge of the roof flange.

Caution: Disconnect main vehicle power before connecting 12 volt DC power to the MaxxFan!

Step 4

Using the insulated electrical connectors provided, connect the vehicle 12 volt power to the two **MaxxFan** power wires located on the driver side of the MaxxFan.

Note: The MaxxFan black wire identified with a tag showing (+) must be connected to the vehicle 12 volt (+) positive supply.

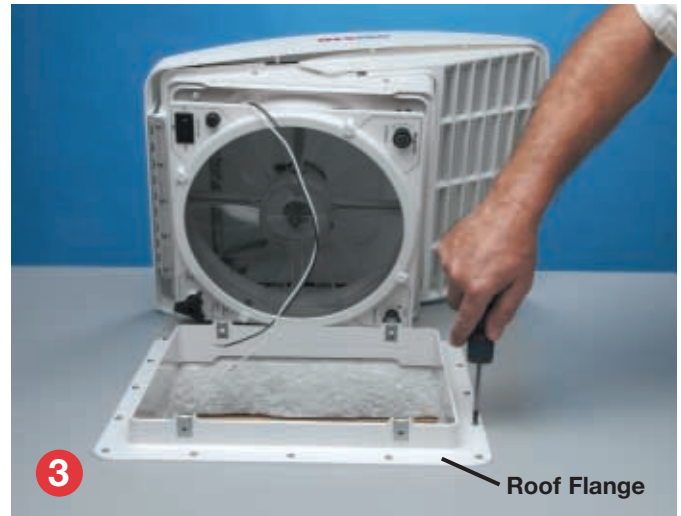

NOTE: After making the 12 volt DC power connections you may re-apply vehicle power and temporarily operate the MaxxFan to verify proper wire connections. Please note that the MaxxFan motor only operates when the MaxxFan is fully opened. Use the Vent Open Knob, pull down and outward to unlock and fully raise the MaxxFan vent lid. (See attached operating instructions.)

Verify that the fan operates in exhaust when the exhaust switch is selected, if not, reverse the 12 volt DC power leads to the MaxxFan and verify correct operation.

Disconnect main vehicle power again before proceeding!

Step 5

Confirm that the 4 metal mounting clips are firmly in place on the Roof Receiving Flange. With the **MaxxFan** open and the exhaust/intake louvers facing the rear of the vehicle, lower the **MaxxFan** onto the Roof Receiving Flange.

Make sure the power wires slide to the vehicle interior and do not become entangled on the Roof Receiving Flange upward edge.

Step 6

Verify the **MaxxFan** is fully seated down on the Roof Receiving Flange and fasten the **MaxxFan** to the Roof Receiving Flange **using the four 3/4 inch long by #10 Stainless Steel screws provided.** (Caution: Only use screws provided/specified for this installation)

This completes the roof top portion of the installation.

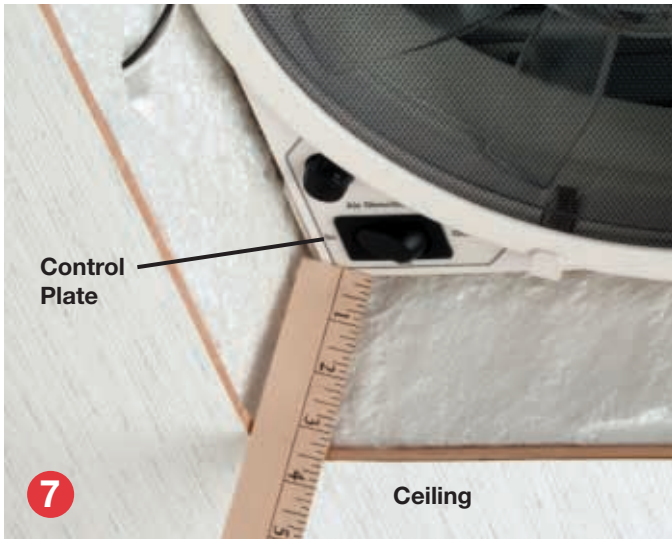

Step 7

The interior Garnish Trim Ring must be trimmed to fit your particular RV roof thickness. To accomplish this, measure the distance from the vehicle ceiling surface to each corner of the MaxxFan Control Plate.

Most RV roofs have some slope, so measuring each corner is necessary. The Garnish ring should be cut 1/4 to 1/2 inch longer than the dimensions measured at each corner.

In the picture shown to the left (#7), the installation, (example only), measures 3 and 1/2 inches from the ceiling to the Control Plate. Go to 7A & 7B.



7A - After adding 1/2 inch more, a line is drawn on the outside of the Garnish Ring at 4 inches.

(Measurements are an example for illustration purposes only.)



7B - Connect all four corners with a line at the required dimension and trim accordingly.



Step 8

Complete the installation by placing any excess wiring to the inside of the roof opening and sliding the Garnish Ring into position. Fasten in place using the four painted flat head screws provided.

For additional information about your MaxxFan, please read the enclosed "Information and Operating Guide".

Congratulations!

You have successfully completed the installation of your new MaxxFan. If there is anything we can do for you, please visit our website www.maxxair.com or call us at: (800) 780-9893



MaxxFan™ Two Year Limited Warranty

MaxxAir Vent Corp. warrants this product to be free of manufacturing defects, regardless of ownership for a period of two years from the original date of purchase. You must keep your original sales receipt. This Limited Warranty does not include failure due to accidents, "Acts of God", misuse, improper installation or incidental damages. During the two year warranty period, if your MaxxFan fails to operate properly under normal conditions, please call MaxxAir toll free at 1-800-780-9893 for assistance. Please have your original sales receipt and MaxxFan Serial Number readily available when you call. The serial number shown on this card is also located on the outer right side of your Control Box, on the interior wall of the fan duct (viewed through roof vent opening from inside your vehicle) and below the rectangular exterior screen on the MaxxFan Housing (located on the roof). MaxxAir will correct a confirmed defect within 45 days by repair or replacement without charge for materials or labor. This warranty does not cover any freight costs for the return of the product to or from MaxxAir Vent Corp., or costs associated with installation, removal or reinstallation of the product. Your MaxxFan is CSA Certified and conforms to UL507.

We invite your comments and suggestions regarding our products. Any information you supply is for MaxxAir's internal use and will not be shared or sold to others.

The Serial number for your MaxxFan is located on the fan control plate under the round insect screen frame. Reference your operating guide. Rotate the four retaining knobs 180° and remove the screen to view. Do not operate the MaxxFan with the screen removed

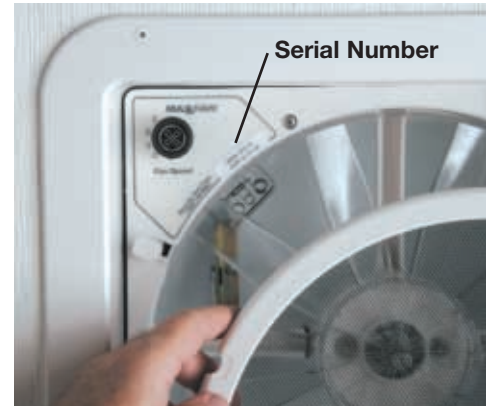

CAUTIONS AND CARE OF THE MaxxFan

This product has been manufactured using prime UV stabilized Polymers for maximum toughness and durability. However, the use of non-compatible chemicals will cause cracking and product failure.

Please clean all parts with mild soap and water only.

Do not use Petroleum Containing Additives or Solvent Based Products on any of the MaxxFan's components or its corrosion resistant hardware.

Listed below are some known chemical products to be aware of:

NON COMPATIBLE CHEMICALS - DO NOT USE THESE

Keytones, Esters, Acetone or other like solvents, Halogenated Hydrocarbons, Amines, Aromatic Hydrocarbons, (Loctite Formulas), or references re: chemicals that are not to be used on Plastics.

GENERALLY COMPATIBLE (But should be used in low concentration where possible)

Acids, Alcohol, Alkalis, Aliphatic Hydrocarbons, Mild Soap solution (avoid strong Alkaline material), Silicone Oil or Greases (avoid those containing Aromatic Hydrocarbons or other additives). **Review the contents of your cleaning materials carefully.**



Visit our website at www.maxxair.com

MaxxAir Vent Corp • 5513 W. Sligh Ave • Tampa, FL 33634 • Phone (800) 780-9893 • (813) 882-8282 • Fax (813) 876-2550